

ICONIC STRUCTURES

TWENTY TWENTY-FIVE CALENDAR

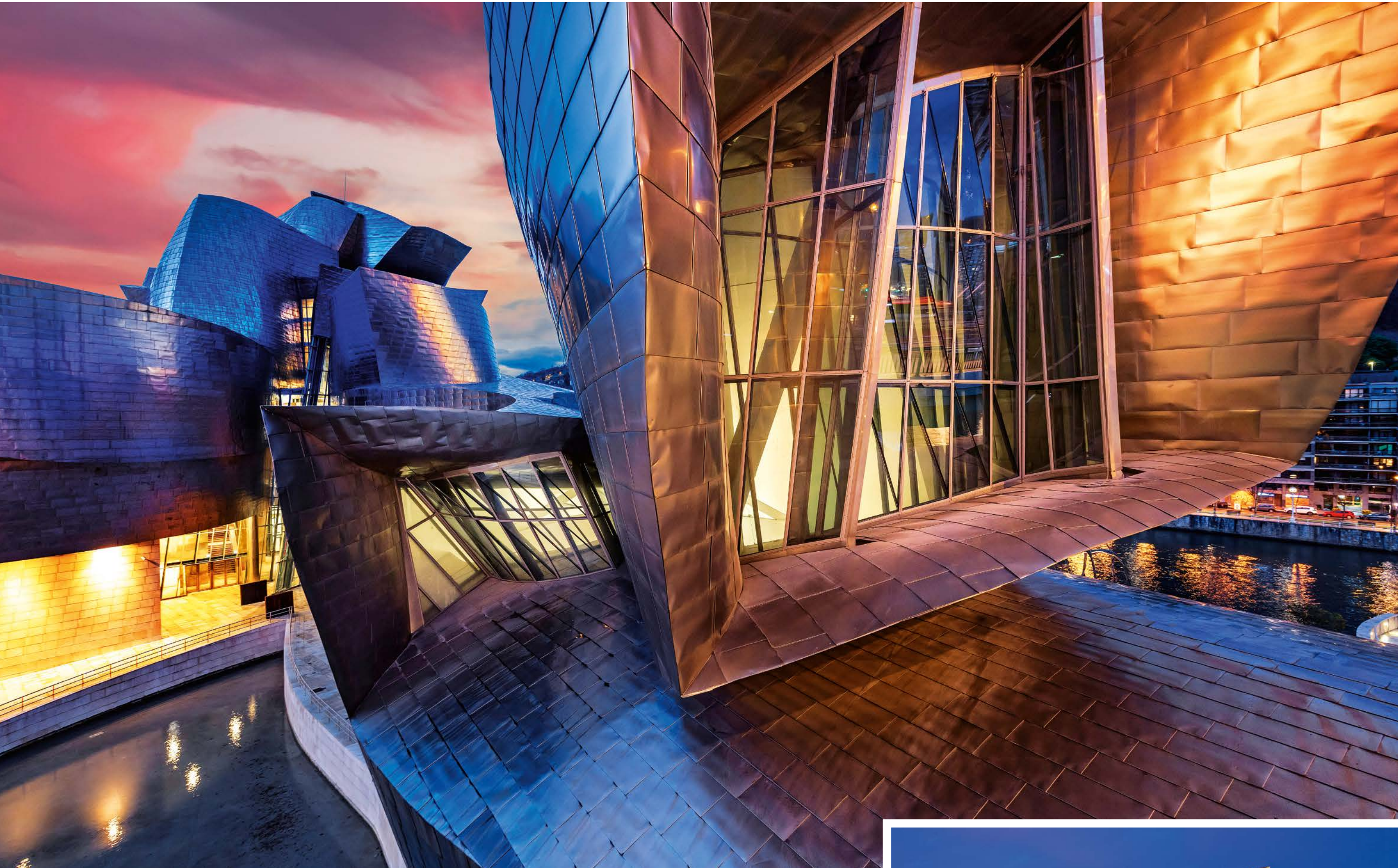



# January 2025

wk	Mon	Tue	Wed	Thu	Fri	Sat	Sun
1			1	2	3	4	5
2	6	7	8	9	10	11	12
3	13	14	15	16	17	18	19
4	20	21	22	23	24	25	26
5	27	28	29	30	31		

# December 2024

wk	Mon	Tue	Wed	Thu	Fri	Sat	Sun
	30	31					1
49	2	3	4	5	6	7	8
50	9	10	11	12	13	14	15
51	16	17	18	19	20	21	22
52	23	24	25	26	27	28	29

# February 2025

wk	Mon	Tue	Wed	Thu	Fri	Sat	Sun
5						1	2
6	3	4	5	6	7	8	9
7	10	11	12	13	14	15	16
8	17	18	19	20	21	22	23
9	24	25	26	27	28		



## Guggenheim Museum, Bilbao, Spain

One of architecture's most groundbreaking designs, built in 1997, the museum reignited the city's economy, and placed Bilbao in the international art and tourism spotlight. From the river it resembles a ship, while its shimmering titanium skin evokes the scales of a fish.



# February 2025

wk	Mon	Tue	Wed	Thu	Fri	Sat	Sun
5						1	2
6	3	4	5	6	7	8	9
7	10	11	12	13	14	15	16
8	17	18	19	20	21	22	23
9	24	25	26	27	28		

# January 2025

wk	Mon	Tue	Wed	Thu	Fri	Sat	Sun
1			1	2	3	4	5
2	6	7	8	9	10	11	12
3	13	14	15	16	17	18	19
4	20	21	22	23	24	25	26
5	27	28	29	30	31		

# March 2025

wk	Mon	Tue	Wed	Thu	Fri	Sat	Sun
10	31					1	2
11	3	4	5	6	7	8	9
12	10	11	12	13	14	15	16
13	17	18	19	20	21	22	23
14	24	25	26	27	28	29	30



**Erasmus Bridge, Rotterdam, Netherlands**

A combined cable-stayed and bascule bridge, with hardly any straight angles, the 802m bridge spans the Maas river linking the north and south of the city. It has a 139m-high steel pylon, secured with 40 cables. The shape of the pylon gave the bridge its nickname, 'The Swan'.



# March 2025

wk	Mon	Tue	Wed	Thu	Fri	Sat	Sun
	31					1	2
10	3	4	5	6	7	8	9
11	10	11	12	13	14	15	16
12	17	18	19	20	21	22	23
13	24	25	26	27	28	29	30

# February 2025

wk	Mon	Tue	Wed	Thu	Fri	Sat	Sun
5						1	2
6	3	4	5	6	7	8	9
7	10	11	12	13	14	15	16
8	17	18	19	20	21	22	23
9	24	25	26	27	28		

# April 2025

wk	Mon	Tue	Wed	Thu	Fri	Sat	Sun
14		1	2	3	4	5	6
15	7	8	9	10	11	12	13
16	14	15	16	17	18	19	20
17	21	22	23	24	25	26	27
18	28	29	30				



**Edge, Hudson Yards, New York, USA**

This tower's sky deck is the highest in the Western Hemisphere. Suspended in mid-air, 100 storeys high, it seems to float in the sky. It has a breathtaking glass floor, leaning out on angled glass walls. Guests can sip champagne in the sky and admire 360-degree city views.



# April 2025

wk	Mon	Tue	Wed	Thu	Fri	Sat	Sun
14		1	2	3	4	5	6
15	7	8	9	10	11	12	13
16	14	15	16	17	18	19	20
17	21	22	23	24	25	26	27
18	28	29	30				

# March 2025

wk	Mon	Tue	Wed	Thu	Fri	Sat	Sun
31						1	2
10	3	4	5	6	7	8	9
11	10	11	12	13	14	15	16
12	17	18	19	20	21	22	23
13	24	25	26	27	28	29	30

# May 2025

wk	Mon	Tue	Wed	Thu	Fri	Sat	Sun
18				1	2	3	4
19	5	6	7	8	9	10	11
20	12	13	14	15	16	17	18
21	19	20	21	22	23	24	25
22	26	27	28	29	30	31	



## Raffles City, Hangzhou, China

Located in the emerging riverside CBD of Hangzhou, this development features two 250m twisting towers, a double-curved podium and four link bridges that provide connectivity for 'the city within a city'. The design references the movement of the river in its fluid surfaces.



# May 2025

wk	Mon	Tue	Wed	Thu	Fri	Sat	Sun
18				1	2	3	4
19	5	6	7	8	9	10	11
20	12	13	14	15	16	17	18
21	19	20	21	22	23	24	25
22	26	27	28	29	30	31	

# April 2025

wk	Mon	Tue	Wed	Thu	Fri	Sat	Sun
14		1	2	3	4	5	6
15	7	8	9	10	11	12	13
16	14	15	16	17	18	19	20
17	21	22	23	24	25	26	27
18	28	29	30				

# June 2025

wk	Mon	Tue	Wed	Thu	Fri	Sat	Sun
23	2	3	4	5	6	7	8
24	9	10	11	12	13	14	15
25	16	17	18	19	20	21	22
26	23	24	25	26	27	28	29



## Riverside Museum, Glasgow, UK

Situated on the Clyde waterfront, the award-winning museum houses over 3,000 exhibits from Glasgow's transport and technology collections. The design is inspired by the city's industrial heritage, with its undulating roof and glass walls reflecting the movement of the river.



# June 2025

wk	Mon	Tue	Wed	Thu	Fri	Sat	Sun
	30						1
23	2	3	4	5	6	7	8
24	9	10	11	12	13	14	15
25	16	17	18	19	20	21	22
26	23	24	25	26	27	28	29

# May 2025

wk	Mon	Tue	Wed	Thu	Fri	Sat	Sun
18				1	2	3	4
19	5	6	7	8	9	10	11
20	12	13	14	15	16	17	18
21	19	20	21	22	23	24	25
22	26	27	28	29	30	31	

# July 2025

wk	Mon	Tue	Wed	Thu	Fri	Sat	Sun
27		1	2	3	4	5	6
28	7	8	9	10	11	12	13
29	14	15	16	17	18	19	20
30	21	22	23	24	25	26	27
31	28	29	30	31			



## The Sphere at the Venetian Resort, Las Vegas, USA

This huge animated 81,300m<sup>2</sup> globe, on the Las Vegas skyline, is billed as the world's largest spherical building and biggest video screen. Clad in 54,000m<sup>2</sup> of LED panels, the event venue boasts an 18,600-seat auditorium, with hi-tech immersive video and audio capabilities.



# July 2025

wk	Mon	Tue	Wed	Thu	Fri	Sat	Sun
27		1	2	3	4	5	6
28	7	8	9	10	11	12	13
29	14	15	16	17	18	19	20
30	21	22	23	24	25	26	27
31	28	29	30	31			

# June 2025

wk	Mon	Tue	Wed	Thu	Fri	Sat	Sun
30							1
23	2	3	4	5	6	7	8
24	9	10	11	12	13	14	15
25	16	17	18	19	20	21	22
26	23	24	25	26	27	28	29

# August 2025

wk	Mon	Tue	Wed	Thu	Fri	Sat	Sun
31					1	2	3
32	4	5	6	7	8	9	10
33	11	12	13	14	15	16	17
34	18	19	20	21	22	23	24
35	25	26	27	28	29	30	31



## Prospect Place, Battersea, London, UK

With its standout rippled white façades punctured by large windows, the Prospect Place housing development, at the old Battersea Power Station, contains two prominent buildings with a total of over 300 homes. It was the first housing project in the UK realised by Frank Gehry.





# August 2025

wk	Mon	Tue	Wed	Thu	Fri	Sat	Sun
31					1	2	3
32	4	5	6	7	8	9	10
33	11	12	13	14	15	16	17
34	18	19	20	21	22	23	24
35	25	26	27	28	29	30	31

# July 2025

wk	Mon	Tue	Wed	Thu	Fri	Sat	Sun
27		1	2	3	4	5	6
28	7	8	9	10	11	12	13
29	14	15	16	17	18	19	20
30	21	22	23	24	25	26	27
31	28	29	30	31			

# September 2025

wk	Mon	Tue	Wed	Thu	Fri	Sat	Sun
36	1	2	3	4	5	6	7
37	8	9	10	11	12	13	14
38	15	16	17	18	19	20	21
39	22	23	24	25	26	27	28
40	29	30					

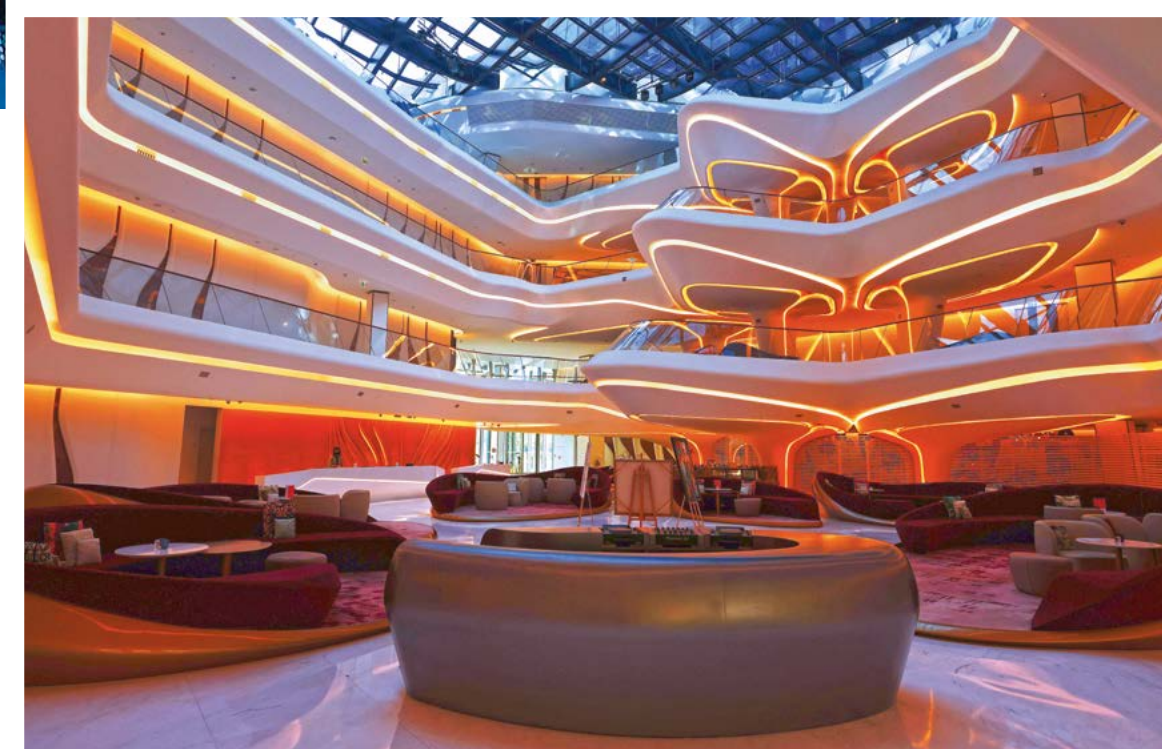

## The Opus, Dubai, UAE

The Opus by Zaha Hadid, in Dubai's Business Bay district, is an architectural wonder. A giant glass cube with a 'carved' central void, the hotel is actually two separate towers, joined at top and bottom by an asymmetric, three-storey bridge, to create the front-facing façade.



# September 2025

wk	Mon	Tue	Wed	Thu	Fri	Sat	Sun
36	1	2	3	4	5	6	7
37	8	9	10	11	12	13	14
38	15	16	17	18	19	20	21
39	22	23	24	25	26	27	28
40	29	30					

# August 2025

wk	Mon	Tue	Wed	Thu	Fri	Sat	Sun
31					1	2	3
32	4	5	6	7	8	9	10
33	11	12	13	14	15	16	17
34	18	19	20	21	22	23	24
35	25	26	27	28	29	30	31

# October 2025

wk	Mon	Tue	Wed	Thu	Fri	Sat	Sun
40			1	2	3	4	5
41	6	7	8	9	10	11	12
42	13	14	15	16	17	18	19
43	20	21	22	23	24	25	26
44	27	28	29	30	31		



**Equinor Oslo, Fornebu, Norway**

A bold modular design, the Oslo offices for the energy company Equinor comprises five identical lamellae stacked on top of one another, crisscrossing and overhanging. The modules are orientated differently to optimise internal daylight conditions and views towards the fjord landscape.



# October 2025

wk	Mon	Tue	Wed	Thu	Fri	Sat	Sun
40			1	2	3	4	5
41	6	7	8	9	10	11	12
42	13	14	15	16	17	18	19
43	20	21	22	23	24	25	26
44	27	28	29	30	31		

# September 2025

wk	Mon	Tue	Wed	Thu	Fri	Sat	Sun
36	1	2	3	4	5	6	7
37	8	9	10	11	12	13	14
38	15	16	17	18	19	20	21
39	22	23	24	25	26	27	28
40	29	30					

# November 2025

wk	Mon	Tue	Wed	Thu	Fri	Sat	Sun
44						1	2
45	3	4	5	6	7	8	9
46	10	11	12	13	14	15	16
47	17	18	19	20	21	22	23
48	24	25	26	27	28	29	30



## CapitaSpring, Singapore

Orthogonal lines, lush greenery and contrasting textures define this high-rise. The vertical lines are pulled apart to allow views into the green oases blooming from the building and rooftop 'sky garden'. With 80,000 plants, it underpins Singapore's status as a garden city.



# November 2025

wk	Mon	Tue	Wed	Thu	Fri	Sat	Sun
44						1	2
45	3	4	5	6	7	8	9
46	10	11	12	13	14	15	16
47	17	18	19	20	21	22	23
48	24	25	26	27	28	29	30

# October 2025

wk	Mon	Tue	Wed	Thu	Fri	Sat	Sun
40			1	2	3	4	5
41	6	7	8	9	10	11	12
42	13	14	15	16	17	18	19
43	20	21	22	23	24	25	26
44	27	28	29	30	31		

# December 2025

wk	Mon	Tue	Wed	Thu	Fri	Sat	Sun
49	1	2	3	4	5	6	7
50	8	9	10	11	12	13	14
51	15	16	17	18	19	20	21
52	22	23	24	25	26	27	28
1	29	30	31				



**Harbin Grand Theatre, Heilongjiang, China**

The sinuous design of this performing arts centre for Harbin Cultural Island, swathed entirely in white aluminium panels, blends in with the harsh landscape, swooping and swirling like a snowdrift. The interior achieves harmony with white walls, skylights and tons of timber.



# December 2025

wk	Mon	Tue	Wed	Thu	Fri	Sat	Sun
49	1	2	3	4	5	6	7
50	8	9	10	11	12	13	14
51	15	16	17	18	19	20	21
52	22	23	24	25	26	27	28
1	29	30	31				

# November 2025

wk	Mon	Tue	Wed	Thu	Fri	Sat	Sun
44						1	2
45	3	4	5	6	7	8	9
46	10	11	12	13	14	15	16
47	17	18	19	20	21	22	23
48	24	25	26	27	28	29	30

# January 2026

wk	Mon	Tue	Wed	Thu	Fri	Sat	Sun
1				1	2	3	4
2	5	6	7	8	9	10	11
3	12	13	14	15	16	17	18
4	19	20	21	22	23	24	25
5	26	27	28	29	30	31	

**Azabudai Hills Mori JP Tower, Tokyo, Japan**

The Mori JP Tower measures 325.2m, Japan's tallest building on completion. With curving edges and a crown resembling flower petals, it is part of a 'modern urban village', a series of low-rise buildings amidst lush greenery, with a central square in central Tokyo.